



ANSI CLASS 150 STAINLESS STEEL SWING CHECK VALVE

FIG. VT-WCF Class 150, Flanged ends, Bolted cover, 316 Stainless steel body & trim.



Flange dimensions: ANSI B16.5
 Face-to-Face dimensions: ANSI B16.10
 Wall thickness: ANSI B16.34/API 603
 Testing: API 598

Materials:

| No. | Part Name | Specification |
|-----|-------------|----------------|
| 1 | Body | ASTM A351-CF8M |
| 2 | Cover | ASTM A351-CF8M |
| 3 | Disc | ASTM A351-CF8M |
| 4 | Gasket | 15% RPTFE |
| 5 | Arm | ASTM A351-CF8M |
| 6 | Studs | ASTM A193-B8 |
| 7 | Nuts | ASTM A194-8 |
| 8 | Cotter pin | AISI 316 |
| 9 | Hinge pin | AISI 316 |
| 10 | Plug gasket | PTFE |
| 11 | Plug | AISI 316 |

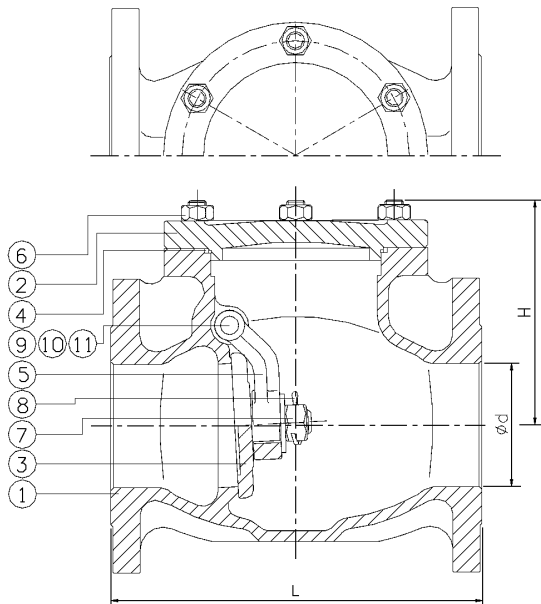

Dimensions:

| Size | | L | | H | | i d | | Weight | |
|------|-----|-------|-----|-------|-----|------|-----|--------|------|
| in | mm | in | mm | in | mm | in | mm | lb | kg |
| 1" | 25 | 5.32 | 135 | 2.95 | 75 | .98 | 25 | 9 | 4 |
| 1½" | 40 | 6.50 | 165 | 3.74 | 95 | 1.57 | 40 | 17 | 7.5 |
| 2" | 50 | 8.00 | 203 | 4.33 | 110 | 1.96 | 50 | 23 | 10.5 |
| 2½" | 65 | 8.50 | 216 | 4.72 | 120 | 2.56 | 65 | 31 | 14 |
| 3" | 80 | 9.50 | 241 | 4.72 | 120 | 3.15 | 80 | 44 | 20 |
| 4" | 100 | 11.50 | 292 | 6.3 | 160 | 3.94 | 100 | 73 | 33 |
| 6" | 150 | 14.00 | 356 | 7.28 | 185 | 5.91 | 150 | 119 | 54 |
| 8" | 200 | 19.50 | 495 | 9.84 | 250 | 7.87 | 200 | 180 | 82 |
| 10" | 250 | 24.50 | 622 | 13.39 | 340 | 9.84 | 250 | 304 | 138 |
| 12" | 300 | 27.50 | 698 | 14.8 | 376 | 11.8 | 300 | 548 | 249 |