

# Class 150 Swing Check Valve

Pressure-Temperature Rating: ASME B16.34

**AK 150UOM** Threaded Ends

**AW150UOM** Socket Welding Ends

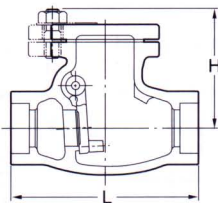
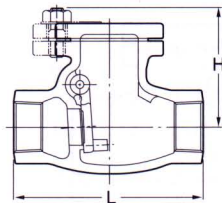

| Parts          | Material        |
|----------------|-----------------|
| Body           | CF3M            |
| Cover          | CF8M            |
| Disc           | CF8M            |
| Hinge pin      | 316             |
| Plug           | 316             |
| Gasket         | Refer to Page 6 |
| Cover bolt/nut | B8/8            |
| Name plate     | Aluminum        |

End-to-End Dimensions: KITZ Std.  
 Connecting Threads: ASME B1.20.1  
 Connecting Sockets: ASME B16.11  
 Wall Thickness: ASME B16.34

| Size | AK150UOM |      |      |     |       |     | AW150UOM |     |     |       |     |  |
|------|----------|------|------|-----|-------|-----|----------|-----|-----|-------|-----|--|
|      | in.      | 1/2  | 3/4  | 1   | 1 1/2 | 2   | 1/2      | 3/4 | 1   | 1 1/2 | 2   |  |
|      | mm       | 15   | 20   | 25  | 40    | 50  | 15       | 20  | 25  | 40    | 50  |  |
| L    | in.      | 3.75 | 3.75 | 5.0 | 6.0   | 6.5 | 3.6      | 3.6 | 4.9 | 5.9   | 6.4 |  |
|      | mm       | 95   | 95   | 127 | 152   | 165 | 92       | 92  | 124 | 149   | 162 |  |
| H    | in.      | 2.8  | 3.0  | 3.2 | 4.1   | 4.7 | 2.8      | 3.0 | 3.2 | 4.1   | 4.7 |  |
|      | mm       | 70   | 75   | 81  | 104   | 120 | 70       | 75  | 81  | 104   | 120 |  |