

1000 WOG - 1 PIECE REDUCED PORT STAINLESS STEEL BALL VALVE

FIG. V1



Ends: MSS SP-110, ASME B16.25, MSS SP-72
 Marking: MSS SP-25
 Threaded ends: ANSI B1.20.1
 Size range: 1/4" to 2"
 Pressure 1/4" to 2": 1000 psi (WOG)

Materials:

No.	Part Name	Specification
1	Body	ASTM A351-CF8M
2	Insert	ASTM A351-CF8M
3	Ball	ASTM A351-CF8M
4	Seat	15% RPTFE
5	Joint Gasket	15% RPTFE
6	Stem	ANSI 316
7	Thrust Washer	15% RPTFE
8	Stem Packing	15% RPTFE
9	Stem Washer	ANSI 304
10	Handle	ANSI 304
11	Spring Washer	ANSI 304
12	Stem Nut	ANSI 304
13	Belleville Washer	ANSI 304
14	Handle Sleeve	Vinyl
15	Locking Device	ANSI 304

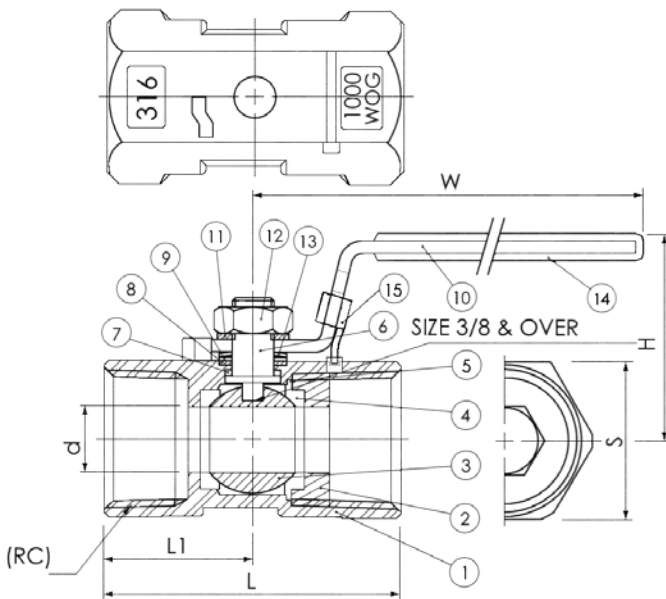

Options:

- L: Locking Device

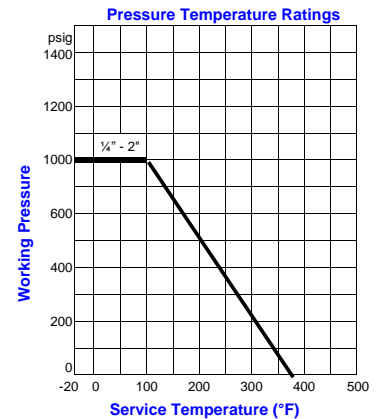

DIMENSIONS.

Size		i d		L		L1		S		H		W		Weights	
in	mm	in	mm	in	mm	in	mm	in	mm	in	mm	in	mm	lb	kg
1/4"	8	.20	5	1.54	39	.75	19	.67	17	1.38	35	2.60	66	.15	.070
3/8"	10	.28	7	1.73	44	.83	21	.83	21	1.42	36	2.91	74	.22	.102
1/2"	15	.36	9.2	2.22	56.5	1.08	27.5	.98	25	1.61	41	3.50	89	.37	.166
3/4"	20	.49	12.5	2.32	59	1.18	30	1.26	32	1.73	44	3.50	89	.54	.247
1"	25	.63	16	2.80	71	1.42	36	1.50	38	2.01	51	4.13	105	.91	.412
1 1/4"	32	.79	20	3.07	78	1.54	39	1.89	48	2.20	56	4.13	105	1.49	.672
1 1/2"	40	.96	24.5	3.27	83	1.64	41.7	2.09	53	2.52	64	5.12	130	1.84	.838
2"	50	1.26	32	3.94	100	1.97	50	2.56	65	2.80	71	5.12	130	3.04	1.384