

Class 150 Cast Carbon Steel Globe Valve

Bolted bonnet, Outside screw-and-yoke, Rising stem and handwheel, Swivel disc.

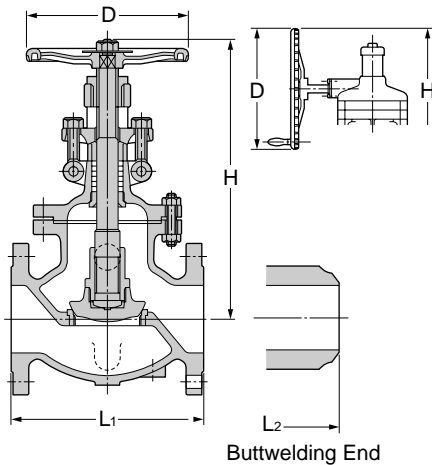

150 SCJ



Gear Operation for 10" and larger Hammer-blow Type Handwheel for 6" & 8"

Fig	End Connections
150 SCJ	RF-flanged with smooth finish on gasket surface.
W150 SCJ	Butt-welding ends.

Standard materials of parts

Parts	Materials
Body	ASTM A216 Gr.WCB
Bonnet	ASTM A216 Gr.WCB
Stem	ASTM A276 Tp.403
Disc	ASTM A182 Gr.F6a (1 1/2" - 5") ASTM A105 + 13Cr (6" & larger)
Lock nut	ASTM A182 Gr.F6a
Body seat ring	ASTM A182 Gr.F6a
Gland	ASTM A182 Gr.F6a
Gland packing	See Page 7.
Gland flange	ASTM A105 ASTM A276 Tp.403 (10" and larger)
Handwheel	Ductile iron
Gasket	See Page 7.
Bonnet bolt / nut	ASTM A193 Gr.B7/A194 Gr.2H
Gland bolt / nut	ASTM A576 Gr.1045/A194 Gr.2H
Bonnet bush	ASTM A182 Gr.F6a ASTM A439 Tp.D2 (10" and larger)
Yoke bush	ASTM A439 Tp.D2

Note: Refer to Page 2 & 3 for standard seat material and construction.

Dimensions

Valve Size	in	1 1/2	2	2 1/2	3	4	5	6	8	10	12	14	16	18
	mm	40	50	65	80	100	125	150	200	250	300	350	400	450
L ₁	in	6.50	8.00	8.50	9.50	11.50	14.00	16.00	19.50	24.50	27.50	31.00	36.00	38.50
	mm	165	203	216	241	292	356	406	495	622	698	787	914	978
L ₂	in	6.50	8.00	8.50	9.50	11.50	14.00	16.00	19.50	24.50	27.50	31.00	36.00	38.50
	mm	165	203	216	241	292	356	406	495	622	698	787	914	978
H	in	12.2	13.1	14.1	15.4	18.1	19.1	20.2	24.8	37.6	40.4	42.6	48.1	51.4
	mm	310	332	359	390	460	484	513	630	955	1025	1082	1222	1305
D	in	7.9	7.9	8.9	9.8	9.8	11.8	13.8	15.7	19.7	19.7	19.7	23.6	23.6
	mm	200	200	225	250	250	300	350	400	500	500	500	600	600

Class 300 Cast Carbon Steel Globe Valve

Bolted bonnet, Outside screw-and-yoke, Rising stem and handwheel, Swivel disc.



300 SCJ

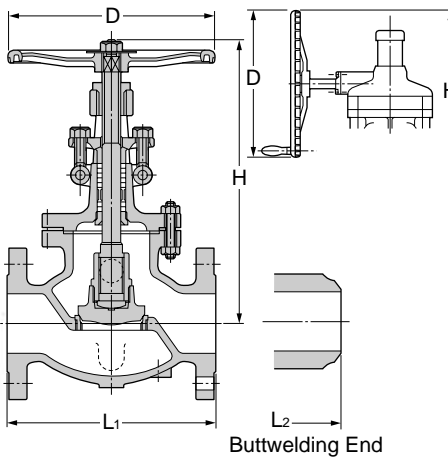

Gear Operation for 8" and larger Hammer-blow Type Handwheel for 5" & 6"

Fig	End Connections
300 SCJ	RF-flanged with smooth finish on gasket surface.
W300 SCJ	Butt-welding ends.

Standard materials of parts

Parts	Materials
Body	ASTM A216 Gr.WCB
Bonnet	ASTM A216 Gr.WCB
Stem	ASTM A276 Tp.403
Disc	ASTM A182 Gr.F6a (1 1/2" - 5") ASTM A105 + 13Cr (6" & larger)
Lock nut	ASTM A182 Gr.F6a
Body seat ring	ASTM A182 Gr.F6a
Gland	ASTM A182 Gr.F6a
Gland packing	See Page 7.
Gland flange	ASTM A105
Handwheel	Ductile iron
Gasket	See Page 7.
Bonnet bolt / nut	ASTM A193 Gr.B7/A194 Gr.2H
Gland bolt / nut	ASTM A576 Gr.1045/A194 Gr.2H
Bonnet bush	ASTM A182 Gr.F6a
Yoke bush	ASTM A439 Tp.D2
Collar	ASTM A182 Gr.F6a

Note: Refer to Page 2 & 3 for standard seat material and construction.

Dimensions

Valve Size	in	1 1/2	2	2 1/2	3	4	5	6	8	10	12	14	16
	mm	40	50	65	80	100	125	150	200	250	300	350	400
L ₁	in	9.00	10.50	11.50	12.50	14.00	15.75	17.50	22.00	24.50	28.00	33.00	34.00
	mm	229	267	292	318	356	400	444	559	622	711	838	864
L ₂	in	9.00	10.50	11.50	12.50	14.00	15.75	17.50	22.00	24.50	28.00	33.00	34.00
	mm	229	267	292	318	356	400	444	559	622	711	838	864
H	in	13.4	14.3	15.8	17.4	20.1	24.0	27.0	40.9	44.9	46.7	55.7	57.9
	mm	341	362	402	441	510	610	685	1038	1141	1186	1415	1470
D	in	7.9	7.9	9.8	9.8	13.8	15.7	17.7	19.7	23.6	23.6	23.6	23.6
	mm	200	200	250	250	350	400	450	500	600	600	600	600