

# WEIGHTS & DIMENSIONS 2500# STAINLESS STEEL FLANGES

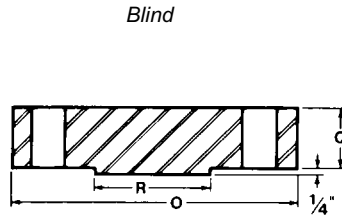
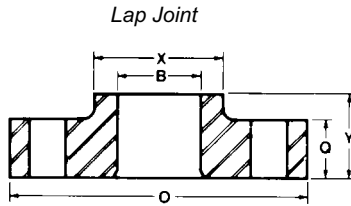

Nominal Pipe Size	Diameter of Bolt Circle	Drilling			Length of Studs		Approximate Weight in Pounds			
		Number of Bolts	Diameter of Bolts	Diameter of Holes	1/4" Raised Face	Ring Joint	Welding Neck	Slip-On and Threaded	Lap Joint	Blind
1/2	3-1/2	4	3/4	7/8	4-3/4	4-3/4	8	7	7	7
3/4	3-3/4	4	3/4	7/8	4-3/4	4-3/4	9	9	9	10
1	4-1/4	4	7/8	1	5-1/4	5-1/4	13	12	12	12
1-1/4	5-1/8	4	1	1-1/8	5-3/4	6	20	18	18	18
1-1/2	5-3/4	4	1-1/8	1-1/4	6-1/2	6-3/4	28	25	25	25
2	6-3/4	8	1	1-1/8	6-3/4	7	42	38	38	39
2-1/2	7-3/4	8	1-1/8	1-1/4	7-1/2	7-3/4	52	52	55	56
3	9	8	1-1/4	1-3/8	8-1/2	8-3/4	94	83	83	86
4	10-3/4	8	1-1/2	1-5/8	9-3/4	10-1/4	146	127	127	133
5	12-3/4	8	1-3/4	1-7/8	11-1/2	12-1/4	244	210	210	223
6	14-1/2	8	2	2-1/8	13-1/2	14	378	323	323	345
8	17-1/4	12	2	2-1/8	15	15-1/2	576	485	485	533
10	21-1/4	12	2-1/2	2-5/8	19	20	1068	925	925	1025
12	24-3/8	12	2-3/4	2-7/8	21	22	1608	1300	1300	1464

All dimensions are in inches.